



## ACCESS flexibility.

HID's iCLASS® 13.56 MHz read/write contactless smart card technology enables numerous applications and supports future growth for an organization's credential program. A unique form factor, the iCLASS Key II provides the convenience of an iCLASS contactless read/write smart card that is durable for harsh environments.

The size of a typical automotive key, this credential form factor can be placed on a key ring or lanyard and customized for corporate identity and branding purposes. The molded plastic key fob is ideal for diverse applications including access control, network log-on security, parking applications, cashless vending, time and attendance and biometric verification.

### Features:

- ▶ The iCLASS 13.56 MHz read/write contactless smart key technology provides high-speed, reliable communications with high data integrity.
- ▶ iCLASS technology ensures high security with mutual authentication, encrypted data transfer, and 64-bit diversified keys for read/write capabilities.
- ▶ Any existing HID format can be factory or field programmed into the secure HID access control application area.
- ▶ Available in 2k bit (256 Byte), 16k bit (2k Byte) or 32k bit (4k Byte) configurations.
- ▶ Molded plastic enclosure provides durability in harsh environments.

### All 2k bit (256 Byte) iCLASS credentials have the following features:

- ▶ Available in two application area configuration only.
- ▶ Provides the HID standard access control application area and one other application area for user customization.
- ▶ Meets ISO 15693 standard for contactless communications.
- ▶ Provides a cost effective way to improve the security of your access control installation.

### All 16k bit (2k Byte) and 32k bit (4k Byte) iCLASS credentials have the following features:

- ▶ Sufficient read/write memory to store multiple biometric templates.
- ▶ 16k available in a two or sixteen application area configuration. 32k available with 16k memory configured in either 2 or 16 application areas, plus an additional 16k user configurable memory.
- ▶ Meets ISO 15693 and 14443B for contactless communications.

# Features

## Read/write Functionality for Multi-functional Memory Applications

iCLASS® was specifically designed to make access control more powerful, more versatile, and more secure. All radio frequency data transmission between the key and reader is encrypted using a secure algorithm. By using industry standard encryption techniques, iCLASS reduces the risk of compromised data or duplicated keys. Multiple securely separated application areas are each protected by 64-bit diversified read/write keys which allow complex applications and provide for future expansion.

Security mechanisms such as mutual authentication and encryption are efficiently combined with fast processing and data communication, resulting in transaction times of less than 100 milliseconds for a typical secure e-purse transaction.

## Proven, Reliable Technology

Offers extremely consistent read range. Unaffected by body shielding or variable environmental conditions.

## Small and Convenient

Can be carried with keys in pocket, handbag, or clipped on a lanyard.

## Long Life

Passive, no-battery design allows for an estimated minimum 100,000 reads.

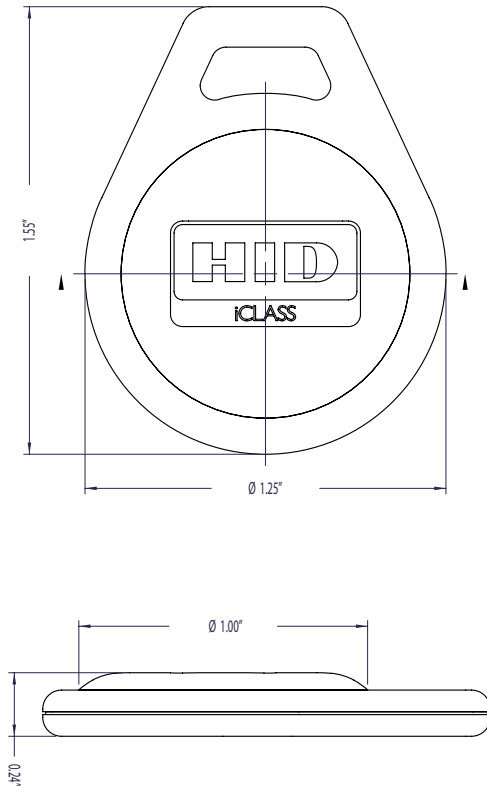

<b>Base Part Number</b>	2050, 2051, 2052, 2053, 2054
<b>Description</b>	RF-programmable, 13.56 kHz, black with blue insert, customer-specified ID Numbers.
<b>*Typical Maximum Read Range</b>	R10 2" (5.1 cm) RP15 1 3/4" (4.6 cm) R30/RW300 2 1/4" (5.9 cm) R40/RW400 2 3/4" (7.0 cm) RK40/RWK400 2" (5.1 cm) RP40 2 1/2" (6.6 cm)
<b>Dimensions</b>	1.555 x 1.25 x 0.235 inches max (3.95 x 3.18 x 0.60 cm)
<b>Key Fob Construction</b>	Ultrasonically welded ABS Shell with TPE insert
<b>Operating Temperature</b>	-50° to 160° F (-45° to 70° C)
<b>Weight</b>	0.14 oz (4.0g)
<b>Memory Size/ Application Areas</b>	2k bit (256 Byte) key – 2 application areas 16k bit (2k Byte) key – 2 or 16 application areas 32k bit (4k Byte) card – 16k bits in 2 or 16 application areas plus 16k bit user configurable.
<b>HID Proximity 125 kHz</b>	No
<b>Contact Smart Chip Module Embeddable</b>	No
<b>Wiegand Stripe</b>	No
<b>Magnetic Stripe</b>	No
<b>Printable</b>	No
<b>Standard HID Artwork</b>	Yes
<b>Slot Punch</b>	Key Ring Hole
<b>Visual Security Options</b>	N/A
<b>Additional Security Options</b>	Corporate 1000
<b>Warranty</b>	Lifetime
<b>Options</b>	Key Ring sold separately (Part Number: 57-0001-02) External card numbering (inkjet or laser engraving). *Dependent upon installation conditions. Tested using Rev "C" readers.



**ACCESS** experience.

### HID Global Offices:

**Corporate North America**  
 15370 Barranca Pkwy  
 Irvine, CA 92618  
 U.S.A.  
 Phone: (800) 237-7769  
 Phone: +1 (949) 732-2000  
 Fax: +1 (949) 732-2360

**Asia Pacific**  
 19/F 625 King's Road  
 North Point  
 Island East  
 Hong Kong  
 Phone: +852 3160-9800  
 Fax: +852 3160-4809

**Latin America**  
 Vasco de Quiroga No. 1900 - 202  
 Centro Ciudad Santa Fé  
 Delegación Alvaro Obregón  
 01210 México, D.F.  
 Tel.: +52 (55) 5081-1650  
 Fax: +52 (55) 5081-1670

**Europe, Middle East & Africa**  
 Phoenix Road  
 Haverhill, Suffolk  
 CB9 7AE  
 England  
 Phone: +44 (0) 1440 714 850  
 Fax: +44 (0) 1440 714 840



For best results, please  
print on recycled paper.

MKT-iCLASSKEY\_DS\_EN

[hidglobal.com](http://hidglobal.com)