

MC 200-S12 PAIR OF MOUNTING FLANGES, ONE FLANGE CONTAINING STRONG MAGNET

- ◆ Designed for recessed-mounting in steel doors and door frames
- ◆ Suitable for MC 240, 246, 247, 250, 270, and 272
- ◆ Fixed with the provided FXS 2.9x13 screws
- ◆ During installation magnetic reed assembly screws into the flange thereby enabling gap distance adjustment for proper contact actuation
- ◆ Available in white or brown plastic
- ◆ 19 mm dia. mounting hole.

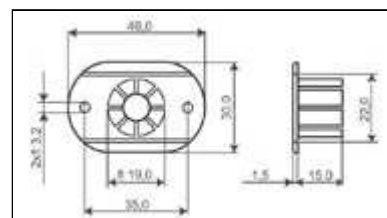

PRODUCT CODE	PRODUCT DESCRIPTION	COLOUR & MATERIAL	PACKAGING
MC 200-S12W	Pair of flanges, one flange contains strong magnet	white plastic	1 set
MC 200-S12B	Pair of flanges, one flange contains strong magnet	brown plastic	1 set